

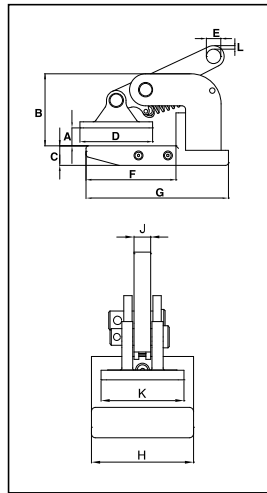

IPHNM10

The IPHNM10 horizontal lifting clamps have a pretension feature that allows the user to attach the clamps to the material for horizontal lifting and transfer of non-sagging material. To be used where material surface must not be damaged. These clamps must be used in pairs or more.



IPH10

The IPH10 horizontal lifting clamps with spring loaded tension have a pretension feature that allows the user to attach the clamps to the material for horizontal lifting and transfer of non-sagging material. These clamps must be used in pairs or more.

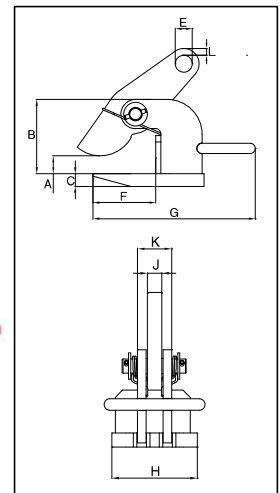

For horizontal lift and transfer with pretension system

- Available in capacities of .5 thru 12 metric tons.
- Jaw openings available: 0 to 120mm.
- Welded alloy steel body for strength and smaller size. Forged alloy components, where required.
- Individually Proof Tested to 2 times the Working Load Limit with certification
- Company name (CrosbyIP), logo, Working Load Limit and jaw opening permanently stamped on body.
- Each product is individually serialized, with the serial number and Proof Load test date stamped on body. User manual with test certificate is included with each clamp.
- Maintenance and repair kits are available.
- Manufactured by an ISO 9001 facility.
- All sizes are **RFID EQUIPPED**.



Load Rated®

Model IPHNM10

Model	Working Load Limit (Per Pair) (t)*	IPHNM10 Stock No.	Weight Each (kg)	Dimensions (mm)										
				Jaw A	B	C	D	E	F	G	H	J	K	L
IPHNM10	.5	2703287	4.0	0 - 20	81	22	82	16	101	160	74	12	60	4
IPHNM10	1	2703288	7.0	0 - 35	93	30	92	16	103	164	74	12	60	7
IPHNM10	2	2703290	15.0	0 - 30	139	30	131	22	166	245	100	20	74	9
IPHNM10J	2	2703291	16.0	30 - 60	169	30	131	22	166	245	100	20	74	9

* Design Factor based on EN 13155 and ASME B30.20.

Model IPH10 and IPH10J: With Spring Loaded Tension, Magnets and Handle

Model	Working Load Limit (Per Pair) (t)*	IPH10 Stock No.	Weight Each (kg)	Dimensions (mm)										
				Jaw A	B	C	E	F	G	H	J	K	L	
IPH10	.5+	2703297	1.8	0 - 20	86	12	16	103	150	60	12	27	4	
IPH10	1+	2703298	2.5	0 - 35	100	16	16	103	150	60	12	31	7	
IPH10	2	2703522	5.5	0 - 60	117	16	22	109	256	110	20	40	9	
IPH10	3	2703523	7.5	0 - 60	117	20	26	109	266	120	20	48	11	
IPH10	4.5	2703524	10.5	0 - 60	132	25	30	104	280	130	20	48	12	
IPH10	6	2703525	13.0	0 - 60	143	25	36	123	320	130	20	48	14	
IPH10	9	2703526	18.5	0 - 60	157	30	43	133	330	140	25	62	16	
IPH10	12	2703527	21.5	0 - 60	172	30	47	141	353	150	25	62	17	
With larger jaw opening #														
IPH10J	3	2703533	18.0	60 - 120	177	20	26	109	266	120	20	48	9	
IPH10J	4.5	2703534	24.0	60 - 120	192	25	30	104	280	130	20	48	11	
IPH10J	6	2703535	30.0	60 - 120	203	25	36	123	320	130	20	48	12	
IPH10J	9	2703536	41.0	60 - 120	217	30	43	133	330	140	25	62	14	
IPH10J	12	2703537	41.0	60 - 120	232	30	47	141	353	150	25	62	16	

* Design Factor based on EN 13155 and ASME B30.20. + No handle or magnets, # Larger Working Load Limits available.

