

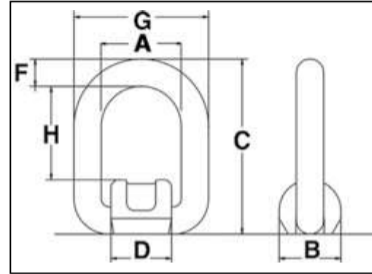

**S-265**  
Weld-On Pivot Link

- Forged Steel — Quenched and Tempered.
- Excellent welding qualities.
- Widely used on farm machinery, trucks, steel hulled marine vessels and material handling equipment.
- Reference American Welding Society specifications for proper welding procedures.



## S-265 Weld-On Pivot Link

Working Load Limit (t)		S-265 Stock No	Weight Each (kg)	Dimensions (mm)							Minimum Fillet Weld Size (mm)
Design Factor 5:1	Design Factor 4:1			A	B	C	D	F	G	H	
1	1.2	1290740	.40	40	36	83	35	13	66	42	3
2.5	3.2	1290768	.60	45	44	99	42	18	81	48	3
4.2	5.3	1290786	1.20	55	50	123	49	22	99	57	6
6.4	8	1290802	2.40	70	64	144	64	26	122	67	6
12	15	1290820	5.90	97	90	193	86	34	165	94	8