

McKissick® Snatch Blocks

SHACKLE FITTING, SINGLE SHEAVE, 2-12t



419



L-170



L-160



417

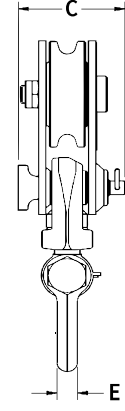
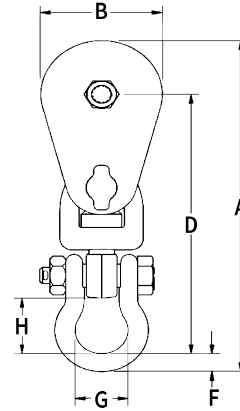

- Opening feature permits easy insertion of rope without reeving, or while the block is suspended.
- Bolt for opening feature is retained, to ensure no lost bolts.
- Forged steel swivel tees, yokes and shackles.
- Can be furnished with bronze bushings or roller bearings.
- Center pin equipped with pressure lube fitting.
- All sizes feature sheave grooves suited for a range of wire line diameters.
- Meets or exceeds all requirements of ASME B30.26 including identification ductility, design factor, proof load and temperature requirements. Importantly, these blocks meet other critical performance

- requirements including fatigue life and material traceability, not addressed by ASME B30.26.
- "All Alloy" snatch blocks feature a significant reduction in weight compared to snatch blocks made of non-alloy materials.
- "Lebus, General Purpose" snatch blocks (with shackle or hook) feature an easy-to-open bolt design. The retaining bolt is released by rotating the fitting assembly, no tools required.
- Crosby's Engineered Solutions Group is ready to discuss your requirements and help select or develop the ideal block for your application. Call us at 1-800-777-1555.

Working Load Limit (t)*	Wire Rope Size (mm)	Sheave Diameter (mm)	Bearing Code	Weight Each (kg)	Catalog No.	Description	Stock No.	Dimensions (mm)							
								A	B	C	D	E	F	G	H
2 tonnes															
2	8 - 10	76	BB	1.8	419 w/Eye	Light Champion	109037†	220	76	67	168	14	14	35	35
2	8 - 10	76	BB	2.3	419	Light Champion	109091	235	76	67	185	13	13	34	40
4 tonnes															
4	10 - 13	114	BB	5.4	419	Light Champion	109064	340	108	79	268	16	18	43	51
5 tonnes															
5	10 - 13 ‡	102	BB	5.0	L-170	Lebus, General Purpose	599828	353	114	75	278	16	18	43	51
5	10 - 13 ‡	102	RB	5.0	L-170	Lebus, General Purpose	599837	353	114	75	278	16	18	43	51
6 tonnes															
6**	10 - 13	127	BB	5.9	L-160	Lebus, Heavy Duty	599524	351	130	94	268	16	18	43	51
6**	10 - 13	127	RB	5.9	L-160	Lebus, Heavy Duty	599533	351	130	94	268	16	18	43	51
8 tonnes															
8	16 - 19	152	BB	12.7	419	Light Champion	109126	481	152	106	373	32	32	76	88
8	16 - 19	152	RB	12.7	419	Light Champion	109153	481	152	106	373	32	32	76	88
8	16 - 19	203	BB	15.0	419	Light Champion	109224	533	206	106	398	32	32	76	88
8	16 - 19	203	RB	15.0	419	Light Champion	109251	533	206	106	398	32	32	76	88
8	16 - 19	254	BB	19.5	419	Light Champion	109322	586	257	106	425	32	32	76	88
8	16 - 19	254	RB	19.5	419	Light Champion	109359	586	257	106	425	32	32	76	88
8	16 - 19	305	BB	24.9	419	Light Champion	109420	657	308	106	471	32	32	76	88
8	16 - 19	305	RB	24.9	419	Light Champion	109457	657	308	106	471	32	32	76	88
8	16 - 19	356	BB	30.4	419	Light Champion	109527	695	359	106	484	32	32	76	88
8	16 - 19	356	RB	30.4	419	Light Champion	109545	695	359	106	484	32	32	76	88
12 tonnes															
12**	16 - 19	146	BB	13.2	L-160	Lebus, Heavy Duty	599588	483	152	106	375	32	32	76	88
12**	16 - 19	146	RB	13.2	L-160	Lebus, Heavy Duty	599597	483	152	106	375	32	32	76	88
12	19 - 22	152	BB	12.7	417	All Alloy	168972	481	152	106	373	32	32	76	88
12	19 - 22	152	RB	12.7	417	All Alloy	193757	481	152	106	373	32	32	76	88
12	19 - 22	203	BB	15.4	417	All Alloy	168990	533	206	106	398	32	32	76	88
12	19 - 22	203	RB	15.4	417	All Alloy	193819	533	206	106	398	32	32	76	88
12	19 - 22	254	BB	19.1	417	All Alloy	193882	586	257	106	425	32	32	76	88
12	19 - 22	254	RB	19.1	417	All Alloy	193935	586	257	106	425	32	32	76	88

* Ultimate Load is 4 times the Working Load Limit, ** Ultimate Load is 3.5 times the Working Load Limit. † Fitted with 1-1/4" ID Swivel Eye. ‡ Special Dual Groove Sheave also accepts 1-1/4" Manilla Rope.